



# Cordless Cleaner DCL280F / DCL281F / DCL282F

## More advanced features for professional use!

High power

+

High durability



# BL MOTOR

# 18V LITHIUM-ION

### DCL280F

**Max Air Flow**  
1.5m<sup>3</sup>/min

**Max Sealed Suction**  
6.0kPa

**Continuous use\***  
20min

Dust capacity  
**750**  
mL

Lightweight  
**1.4**kg  
BL1815N



### DCL281F

**Max Air Flow**  
1.5m<sup>3</sup>/min

**Max Sealed Suction**  
6.0kPa

**Continuous use\***  
Max: 15min  
High: 20min  
Normal: 50min

Dust capacity  
**750**  
mL

Lightweight  
**1.4**kg  
BL1815N

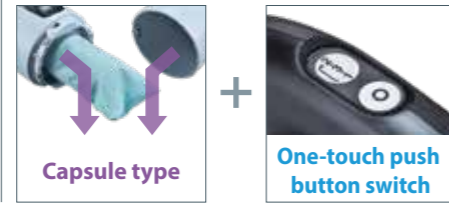

### DCL282F

**Max Air Flow**  
1.5m<sup>3</sup>/min

**Max Sealed Suction**  
6.0kPa

**Continuous use\***  
Max: 15min  
High: 20min  
Normal: 50min

Dust capacity with dust bag  
**500**mL  
Paper filter 330mL

Lightweight  
**1.5**kg  
BL1815N



\*Battery: BL1830B (3.0Ah)

### Accessories

	Nozzle assembly For rug / carpet	Sheet Nozzle	Flexible hose	Corner nozzle	Round brush	Shelf brush
Part No.						
White	A-59950	199037-3	198867-9	198918-8	198877-6	198872-6
Blue	198523-1	199040-4	198541-9	198989-5	198549-3	198534-6

### DCL280F, DCL281F only

<b>Filter set</b> 443060-3	<b>Pre-filter</b>	<b>Easy shake off filter B set</b>	<b>Filter H set</b> <i>HEPA</i> filter Part No. 199989-8
<b>DCL282F only</b>	<b>Paper filter set</b> 5pcs/set	<b>Easy shake off dust bag set</b>	<b>Valve stay complete</b>
<b>Dust bag set</b> (cloth) Part No. 198746-1	Part No. 194566-1	Part No. 198748-7	Part No. 143677-9

### Tool bag set



Cleaner body, battery, charger and accessories can be stored together.  
(LxWxH: 600x210x190mm)



### Holder Set



### Cordless Cleaner

#### DCL280F / DCL281F / DCL282F

	DCL280F	DCL281F	DCL282F
<b>Capacity</b>	800 mL	800 mL	Dust Bag: 500 mL Paper Dust Bag: 330 L
<b>Continuous Use (min.)</b>	20	Max: 15 / High: 20 / Low: 50	Max: 15 / High: 20 / Low: 50
<b>Max Air Flow</b>	1.5 m <sup>3</sup> /min	1.5 m <sup>3</sup> /min	1.5 m <sup>3</sup> /min
<b>Max Sealed Suction (water column)</b>	6.0 kPa (600 mmH <sub>2</sub> O)	6.0 kPa (600 mmH <sub>2</sub> O)	6.0 kPa (600 mmH <sub>2</sub> O)
<b>Suction Power</b>	45 W	Max / High / Low: 60 / 45 / 15 W	Max / High / Low: 60 / 45 / 15 W
<b>Dimensions (L x W x H)</b>	1,018x113x155 mm (40"x4-7/16"x6-1/8")	1,018x113x154 mm (40"x4-7/16"x6-1/8")	1,018x113x154 mm (40"x4-7/16"x6-1/8")
<b>Net weight</b>	1.3 - 1.6 kg (2.9 - 3.6 lbs.)	1.4 - 1.7 kg (3.0 - 3.7 lbs.)	1.4 - 1.7 kg (3.0 - 3.7 lbs.)

**Standard Equipment:** Floor Nozzle, Sash Nozzle, Sash Nozzle Holder, Pipe, Filter, Prefilter, Efficient Collection Filter, Hand Strap, Battery, Charger

Built-in Job Light

Electronic 3-Speed (DCL281F / DCL282F)

### Makita Singapore Pte Ltd

7, Changi South Street 3, Singapore 486348  
Phone : +65-6546-8700 Fax : +65-6546-8711  
Email : salesadv@makita.com.sg  
Website : www.makita.com.sg  
Facebook : www.facebook.com/MakitaSG



MakitaSG



VISIT OUR WEBSITE

PRINTED IN SINGAPORE

### DCL280F

Capsule type



Trigger switch + slide switch

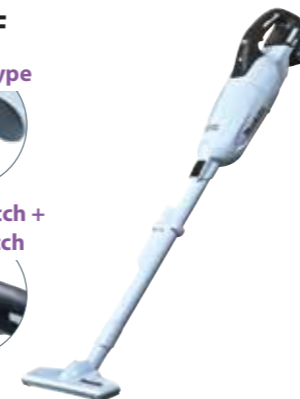

### DCL281F

Capsule type



One-touch push button switch

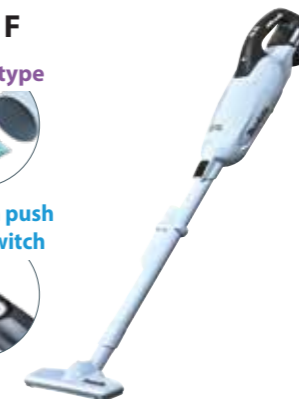

### DCL282F

Paper dust bag



One-touch push button switch



# BL motor provides high power and high durability.

Max Air Flow

**1.5** m<sup>3</sup>/min

Max Sealed Suction

**6.0** kPa



## Trigger switch + Sliding lock-on switch

DCL280F only  
allows for long continuous cleaning with less fatigue.



By moving ① sliding lock-on switch to ON position, ② interlocking trigger switch can be locked on for continuous cleaning.

## LED job light

illuminates the work area.  
also function as a battery capacity warning lamp

photo: DCL280F



**BL**  
MOTOR

**New internal construction prevents loose installation of filter/paper dust bag to protect the motor room from dust.**

## Pipe lock

Pipe is fixed with the locking mechanism to prevent it from accidentally coming off.



## Pipe with beveled end

Cleaning of tight places can be done without nozzle by using the beveled end of pipe as a nozzle.



## Paper dust bag ( DCL282F )



Moving stopper prevents front cover from closing if paper dust bag is not installed tight.



## HEPA filter is available ( DCL280F / DCL281F )

**HEPA**  
filter



## Capsule type ( DCL280F / DCL281F )

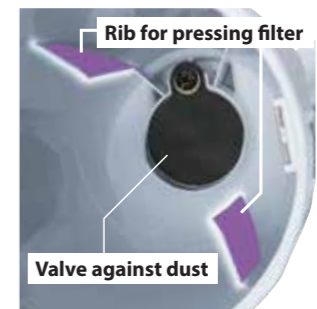

When capsule is installed securely, two ribs inside capsule press the inside frame of filter to hold the filter tight.



## Quiet cleaning & Low vibration

- ① achieved by noise absorbing sponge attached inside housing.
- ② Using softer elastomer for the part that fixes fan cover, the vibration of housing is reduced, increasing comfort even in long continuous cleaning.

